

**TÜRSAT KODU : TKS-KON-02**

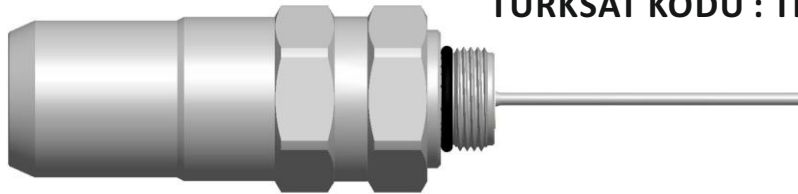

Description: Hardline Connector, G052 – 5/8 Male.  
(Measured with Commscope QR540 ASS Cable)

**DATA SHEET**

**Electrical**

	Specification		Standard
<b>Frequency Range</b>	5 MHz – 3.000 MHz		
<b>Impedance</b>	75 Ω nominal		
	<b>Better Than</b>	<b>Measured</b> – Worst case of 4 measurements	
<b>Return Loss of Assembly</b>	22 dB	≥ 25.1 dB	IEC 61169-1, 9.2.1.4
	17 dB	≥ 20.2 dB	
	16 dB	≥ 19.0 dB	
	15 dB	≥ 18.3 dB	
<b>Gated Return Loss of G052-5/8M</b>	27 dB	≥ 30.0 dB	IEC 61169-1, 9.2.1.4
	22 dB	≥ 25.5 dB	
	21 dB	≥ 24.5 dB	
	20 dB	≥ 23.3 dB	
<b>Insertion Loss of Assembly</b>	0.05 dB	≤ 0.02 dB	
	0.07 dB	≤ 0.04 dB	
	0.07 dB	≤ 0.04 dB	
	0.09 dB	≤ 0.06 dB	
<b>Shielding Effectiveness - Measured with CoMeT</b>	Transfer Impedance @ 5 – 30 MHz		≤ 0.7 mΩ/item
	Screening Attenuation @ 30 – 1.000 MHz		≥ 102.7 dB
	Screening Attenuation @ 1.000 – 2.000 MHz		≥ 99.9 dB
	Screening Attenuation @ 2.000 – 3.000 MHz		≥ 94.5 dB
<b>Common Path Distortion</b>	Class: A+		EN 50117
<b>Inner Conductor Resistance</b>	≤ -110 dBc		ANSI/SCTE 109 2005
<b>Amp. Rating</b>	≤ 1.5 mΩ @ 1 A DC.		IEC 61169-1, 9.2.3
<b>Dielectric Strength</b>	≥ 15 A. @ 60 V.		
<b>Insulation Resistance</b>	≥ 3 KV.		IEC 61169-1, 9.2.1.6
	≥ 29.99 MΩ @ 500 V.		IEC 61169-1, 9.2.1.5

**Environmental**

	Specification	Standard
<b>Temperature range Operating</b>	-40°C to +85°C	
<b>Temperature range Installation</b>	-5°C to +50°C	
<b>Sealing Test</b>	IPX8 – 1 meter / 24 hours	IEC 60529
<b>Red Dye</b>		ANSI/SCTE 60
<b>Corrosion Protection</b>		ASTM B 117-94

**Mechanical**

	Specification	Standard
<b>Interface</b>	5/8 male	ANSI/SCTE 92
<b>Pull Strength</b>	≥ 125 kgf	ANSI/SCTE 99

**Material and Finish**

	Specification	Standard
<b>Housing</b>	NiSn (NITIN) plated Brass	ASTM B605
<b>Compression ring</b>	NiSn (NITIN) plated Brass	ASTM B605
<b>Mandrel</b>	NiSn (NITIN) plated Brass	ASTM B605
<b>Inner Conductor</b>	NiSn (NITIN) plated Brass	ASTM B605
<b>O'ring</b>	EPDM	
<b>Insulator</b>	Polycarbonate/Polyethylene	

All tests performed using instruments calibrated in accordance to our ISO 9001 certification.

Further test reports, technical specifications and installation instructions can be obtained on request.

In order to continue to supply the best products, PPC reserves the right to change the products and specifications at any time without prior notice.

**TÜRKSAT KODU : TKS-KON-04**

**Measurement setup:**

**G052-5/8 Male – Cable – G052-5/8 Male.**

All measurements are done with Commscope QR540 ASS cable.

All results are the worst case of 4 measurement of the setup.

Return Loss, Gated Return Loss (Time Domain Measurement of Return Loss of 1 connector in setup) Insertion Loss and Shielding are measured with hp Network Analyzer hp 8753D and S-Parameter Test Set 85047A, according to IEC standards.

CPD (Common Path Distortion) are measured with hp Spectrum Analyzer hp 8591E, according to ANSI/SCTE standard.

In case of over current ( $\geq 15$  A.) there is a risk for high temperature inside the connector, which will cause damage of the insulator and / or the cable.



Fetih Mah. Libadiye Cad. Tahralı Sok.  
Tahralı Sit. Kavakyeli Plaza C Blok K.1 D.2-3  
Göztepe – Ataşehir / İstanbul-TURKEY  
[www.telcoiletisim.com](http://www.telcoiletisim.com)

